



# Pitch.

Summer Events





# Pitch Wharf

Riverside Terrace





# Pitch Wharf

Pitch Wharf was built with hosting spectacular events all year around in mind, and summer is the perfect time to take advantage of our outdoor terrace overlooking the canal.

The main floor features a panoramic view of The Wharf, 11 simulator bays, a huge bar and a sprawling lounge with live DJ as requested. The huge windows are a feature which our guests love and allow attendees to enjoy a rare mix of gaming with sunlight throughout.

Make the most of the warmer months by extending your event onto our waterfront terrace, ideal for drinks, socialising, and relaxed team-building. For larger events, seamlessly combine indoor and outdoor spaces to create a well-rounded experience.







# Our Games

Experience the modern way to play golf with **virtual games** like Party Putt, Cannon Bowl, and Streets of Neon. Perfect for all skill levels, Trackman games offer challenges from precision tasks to fun showdowns like closest to the pin.

Elevate your event at Pitch with full or half-venue hire, offering activities like **shuffleboard**, **roulette**, **Nintendo Switch** or even casino corner which is always a popular option.

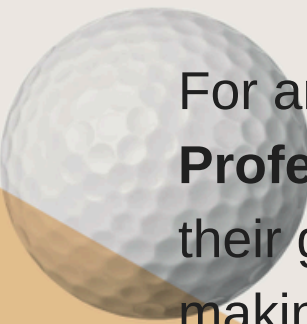

For an added touch, enjoy expert coaching from our **PGA Professionals**—perfect for beginners or those looking to refine their game. Custom arcade games are also available on request, making it ideal for mixed-ability groups.





The image shows a modern lounge interior. In the foreground, there are three shuffleboard tables with dark wood tops and metal frames. Behind them is a bar area with a counter and shelves stocked with bottles. To the right, there are round tables with cane-backed chairs. A staircase with a metal railing is visible on the left. The walls are a warm, light brown color, and the floor is made of light wood. The text "The Shuffle Social." is written on the wall to the left of the shuffleboard tables.

The  
Shuffle  
Social.

# Shuffleboard

Alongside our interactive bays and vibrant social spaces, Pitch Wharf is levelling up with the addition of **three shuffleboard tables!**

This exciting new addition brings more ways to compete, connect, and unwind. Perfect for elevating your events, shuffleboard adds a unique blend of strategy and social play to any occasion.



# Food & Drink

Designed exclusively for Pitch, our JIYŪ menu includes Asian-infused dishes which have been curated by the ex-head chef of the Ivy Steve Tonkin. When mixed with delicious cocktails, Japanese lager and a very modern wine list, your guests will be spoilt for choice.





# Canary Events Packages

Perfect for those regular team rewards or the more budget conscious. Our events packages cater for all.  
Prices are inclusive of VAT

○ Off-Peak  
● Peak



## PAR

Two hours of games  
Two house drinks  
No food  
Reservable area

**£41pp - £45pp**

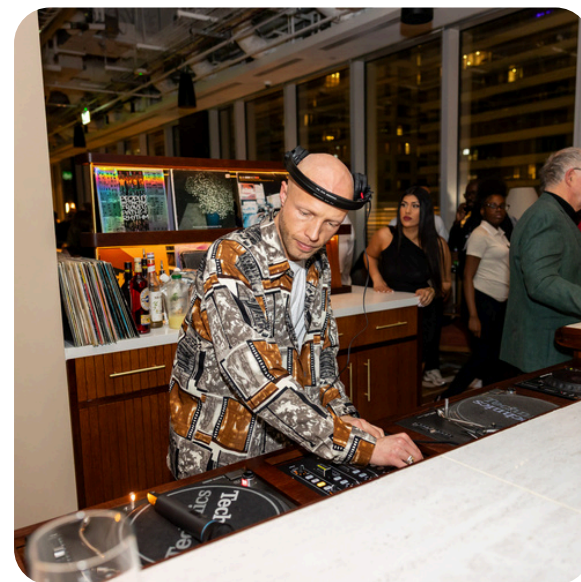

## BIRDIE

Two hours of games  
Two house drinks  
One 'JIYU' dish  
Reservable area

**£51pp - £55pp**



## EAGLE

Two hours of games  
Two premium drinks  
Two 'JIYU' dishes  
Reservable area

**£63pp - £67pp**



## ALBATROSS

Three hours of games  
Three premium drinks  
Three 'JIYU' dishes  
Reservable area

**£91pp - £95pp**



## ACE

Four hours of games  
Four premium drinks  
Three 'JIYU' dishes  
Reservable area

**£106pp - £110pp**

\*two prices show booking during Off-Peak/Peak times (Wednesday & Thursday)



# Canary Wharf Floorplan

## Lower Ground Floor

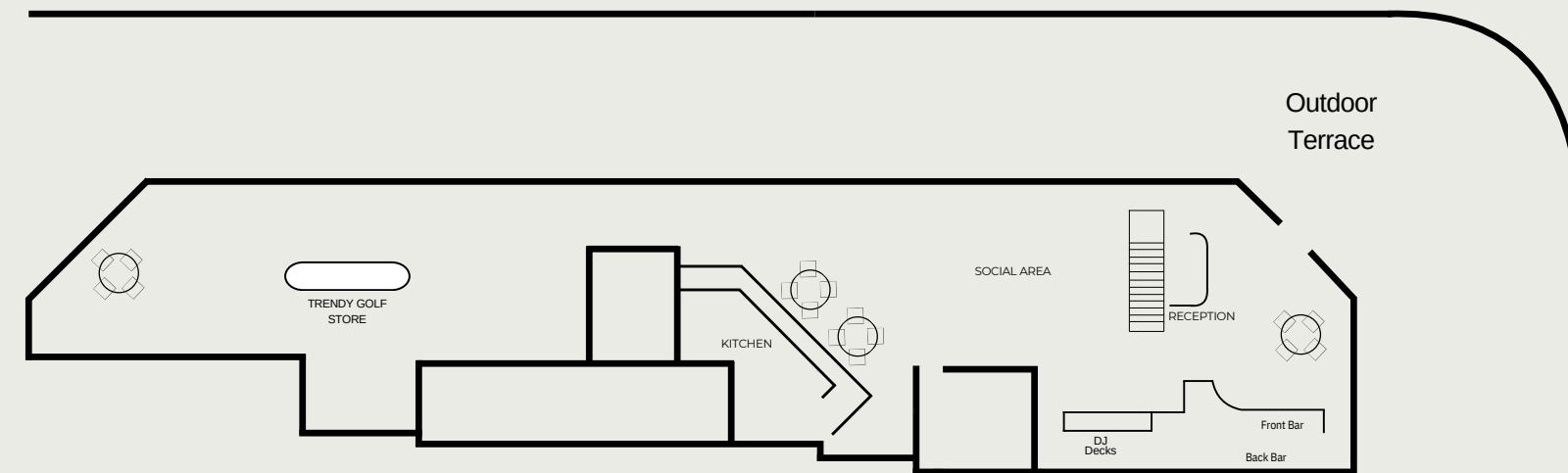

## Ground Floor

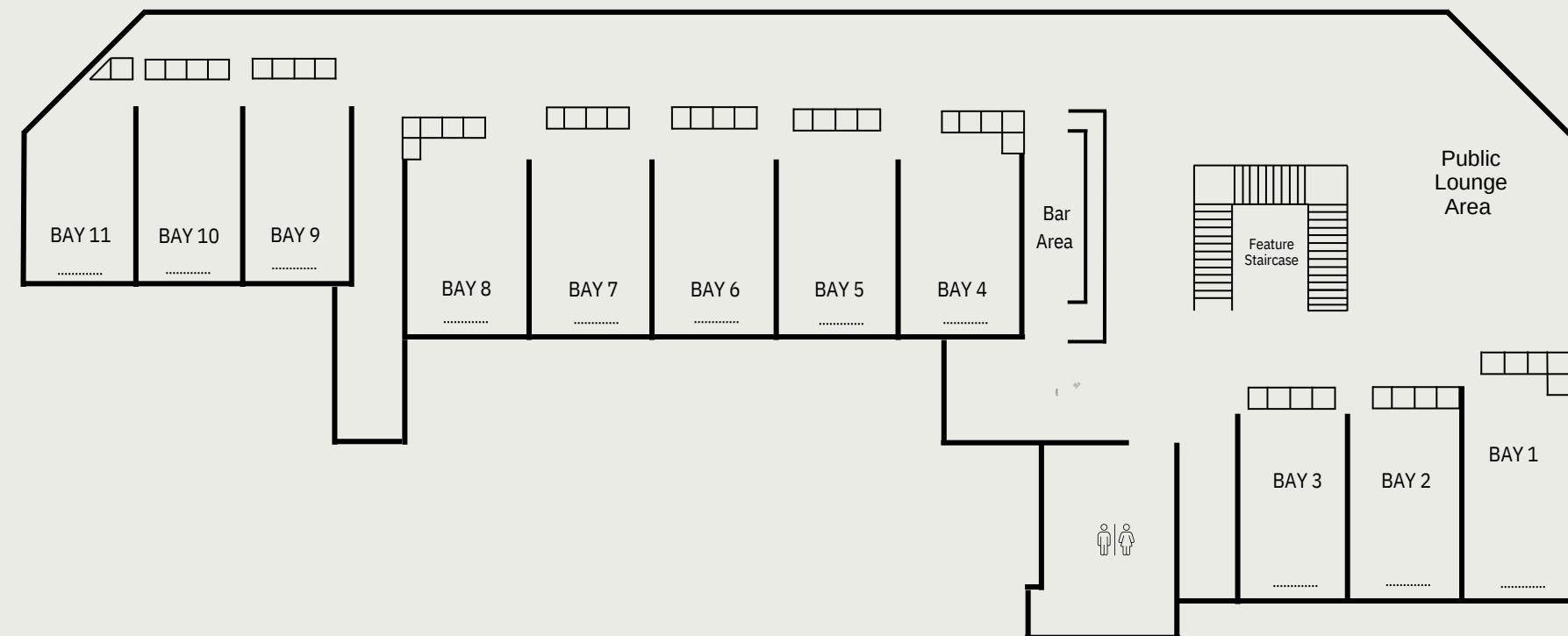

Covering 14,500 square feet, this state-of-the-art space includes:

- Eleven Ultra-HD gaming bays powered by Trackman
- Two bars and a restaurant
- Riverside terrace with seating
- Panoramic View
- Three Shuffleboards



# Outdoor Hire

Our outdoor terrace and downstairs bar offer a fantastic space for enjoying drinks in a relaxed yet vibrant atmosphere, perfect for after-work gatherings or social occasions during the summer months.

With a capacity for up to 150 guests, it provides a stylish setting for hosting colleagues or clients in a comfortable and inviting environment.

There are options to hire the entire outdoor space as a stand alone option or as part of the lower ground floor with dining space, shuffleboard and a live DJ all options to compliment your summer event.

To secure the space, a **minimum spend\* of £1K applies.**

\*Minimum spend varies based on the day and whether the lower ground bar is included.





The word "Pitch" is displayed in large, white, sans-serif capital letters, centered across the middle of the image. It is superimposed over a background of a modern building's glass facade at night. The glass reflects the interior lights and structure of the building, including a curved staircase and a chandelier with multiple spherical bulbs. The overall lighting is warm and ambient, with the white text providing a strong contrast against the darker background.

Pitch

# Contact Us

For any enquiries, please contact our events team:  
[events@pitchldn.co.uk](mailto:events@pitchldn.co.uk)

# Canary

30 Churchill Place  
London  
E14 5EU