



Pitch.

Summer Events



Pitch Wharf

Riverside Terrace



Pitch Wharf

Pitch Wharf was built with hosting spectacular events all year around in mind, and summer is the perfect time to take advantage of our outdoor terrace overlooking the canal.

The main floor features a panoramic view of The Wharf, 11 simulator bays, a huge bar and a sprawling lounge with live DJ as requested. The huge windows are a feature which our guests love and allow attendees to enjoy a rare mix of gaming with sunlight throughout.

Make the most of the warmer months by extending your event onto our waterfront terrace, ideal for drinks, socialising, and relaxed team-building. For larger events, seamlessly combine indoor and outdoor spaces to create a well-rounded experience.



Our Games

Experience the modern way to play golf with **virtual games** like Party Putt, Cannon Bowl, and Streets of Neon. Perfect for all skill levels, Trackman games offer challenges from precision tasks to fun showdowns like closest to the pin.

Elevate your event at Pitch with full or half-venue hire, offering activities like **shuffleboard**, **roulette**, **Nintendo Switch** or even casino corner which is always a popular option.

For an added touch, enjoy expert coaching from our **PGA Professionals**—perfect for beginners or those looking to refine their game. Custom arcade games are also available on request, making it ideal for mixed-ability groups.



The image shows the interior of 'The Shuffle Social', a modern lounge or bar. In the foreground, there are three shuffleboard tables with dark wood tops and metal frames. Behind them, a bar area is visible with shelves of bottles and a counter. To the right, there's a seating area with round tables and chairs. A staircase with a metal railing leads to an upper level. The walls are a warm, light brown color, and the floor is made of light wood. The overall atmosphere is cozy and contemporary.

The
Shuffle
Social.

Shuffleboard

Alongside our interactive bays and vibrant social spaces, Pitch Wharf is levelling up with the addition of **three shuffleboard tables!**

This exciting new addition brings more ways to compete, connect, and unwind. Perfect for elevating your events, shuffleboard adds a unique blend of strategy and social play to any occasion.

Food & Drink

Our food offering will undoubtedly be a standout feature of your special event. When mixed with delicious cocktails, Japanese lager and a very modern wine list, your guests will be spoilt for choice.



Canary Events Packages

Perfect for those regular team rewards or the more budget conscious. Our events packages cater for all.
Prices are inclusive of VAT

○ Off-Peak
● Peak



PAR

Two hours of games
Two house drinks
No food
Reservable area

£41pp - £45pp



BIRDIE

Two hours of games
Two house drinks
One food dish
Reservable area

£51pp - £55pp



EAGLE

Two hours of games
Two premium drinks
Two food dishes
Reservable area

£63pp - £67pp

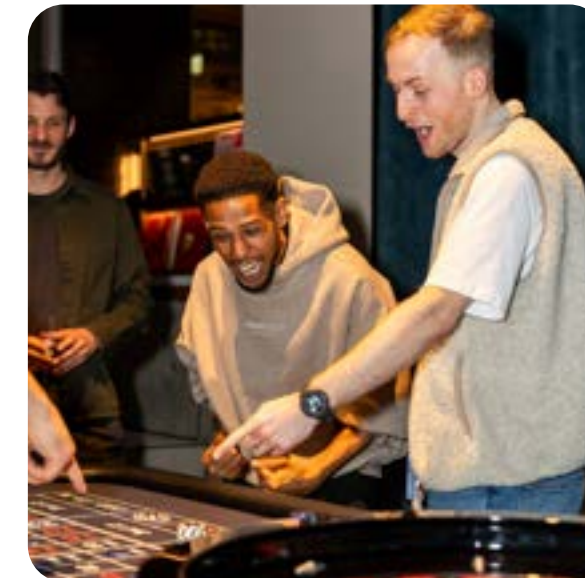

ALBATROSS

Three hours of games
Three premium drinks
Three food dishes
Reservable area

£91pp - £95pp



ACE

Four hours of games
Four premium drinks
Three food dishes
Reservable area

£106pp - £110pp

*two prices show booking during Off-Peak/Peak times (Wednesday & Thursday)

Canary Wharf Floorplan

Lower Ground Floor

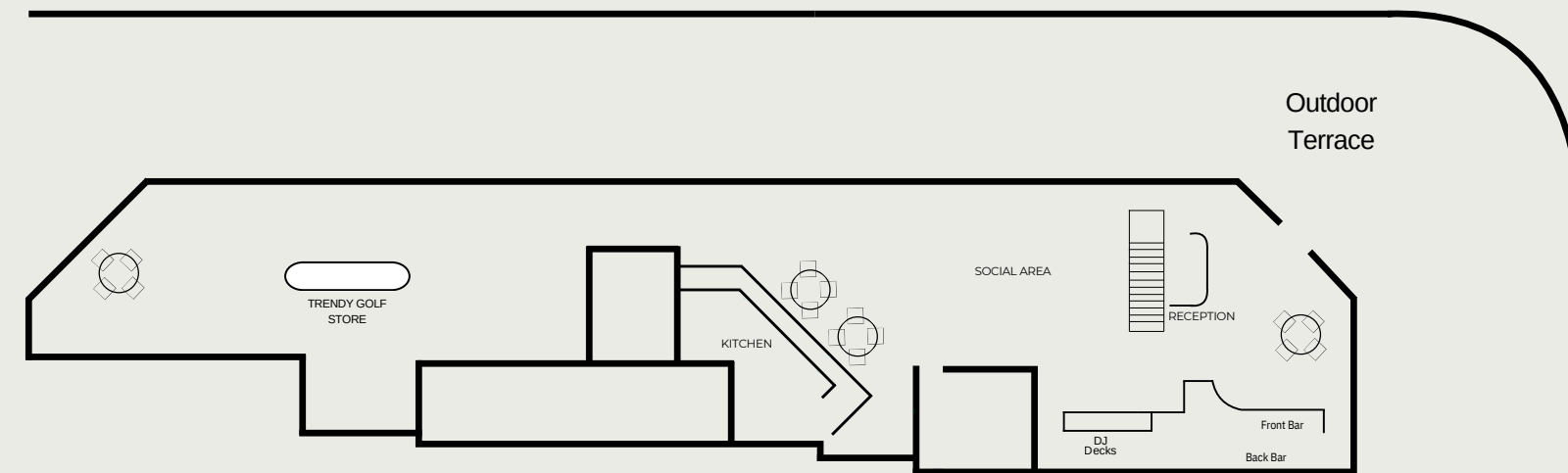

Ground Floor

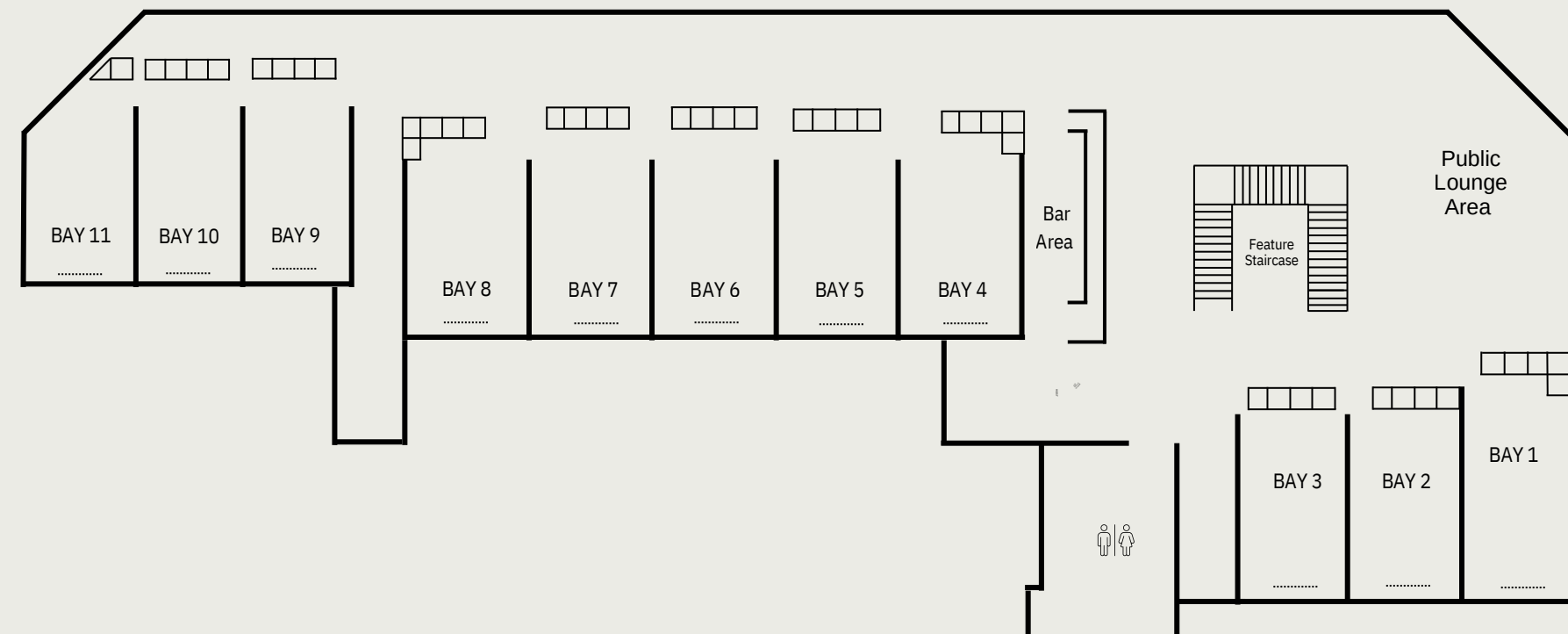

Covering 14,500 square feet, this state-of-the-art space includes:

- Eleven Ultra-HD gaming bays powered by Trackman
- A bar and restaurant
- Riverside terrace with seating
- Panoramic View
- Three Shuffleboards

Outdoor Hire

Our outdoor terrace and downstairs bar offer a fantastic space for enjoying drinks in a relaxed yet vibrant atmosphere, perfect for after-work gatherings or social occasions during the summer months.

With a capacity for up to 150 guests, it provides a stylish setting for hosting colleagues or clients in a comfortable and inviting environment.

There are options to hire the entire outdoor space as a stand alone option or as part of the lower ground floor with dining space, shuffleboard and a live DJ all options to compliment your summer event.

To secure the space, a **minimum spend* of £1K applies.**

*Minimum spend varies based on the day and whether the lower ground bar is included.



The word "Pitch" is displayed in large, white, sans-serif capital letters on a glass wall. The glass reflects the interior of a modern building, showing a curved ceiling with exposed pipes and a chandelier with multiple small, round, warm-toned light bulbs. A green exit sign is visible in the background through the glass.

Pitch

Contact Us

For any enquiries, please contact our events team:
events@pitchldn.co.uk

Canary

30 Churchill Place
London
E14 5EU